

# Specifications

**New!**

## 5W R266

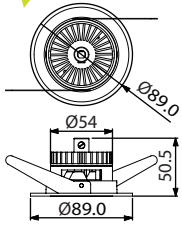

Power Consumption	5W
Field Angle	30°
Color Temperature	CW / WW
CRI	≥ 70
Finish	Silver
Surface Temperature	60 °C
Weight	60 ± 5 g

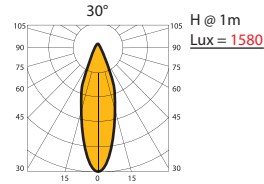
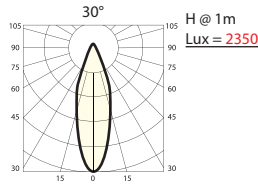

- 5650K ~ 6000K
- 3800K ~ 4100K
- 2800K ~ 3050K

**New!**

## 10W ES111

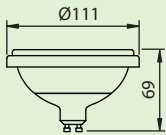

Power Consumption	10W
Field Angle	25° / 40°
Color Temperature	CW / NW / WW
CRI	≥ 70
Finish	White / Silver / Black
Surface Temperature	60 °C
Weight	220 ± 5 g

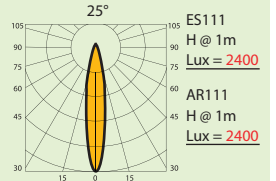
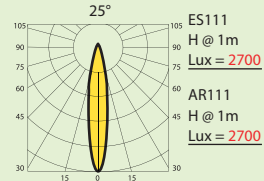
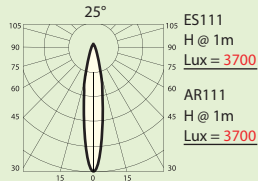

## 10W AR111

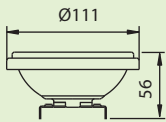

Power Consumption	10W
Field Angle	25° / 40°
Color Temperature	CW / NW / WW
CRI	≥ 70
Finish	White / Silver / Black
Surface Temperature	60 °C
Weight	190 ± 5 g

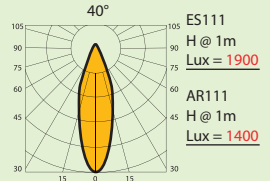
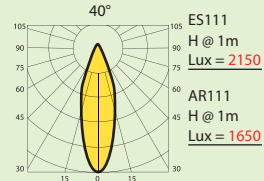
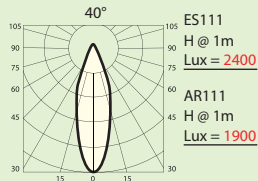

## 10W TD26

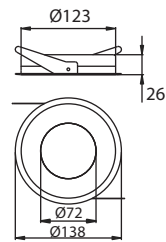

Power Consumption	10W
Field Angle	25° / 40° / 60° / 140°
Color Temperature	CW / NW / WW
CRI	≥ 70
Finish	White / Silver / Others
Surface Temperature	60 °C
Weight	370 ± 5 g

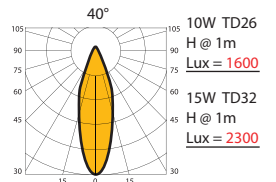
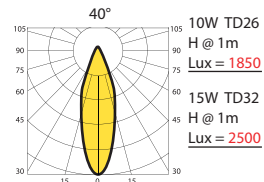
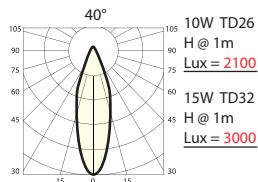
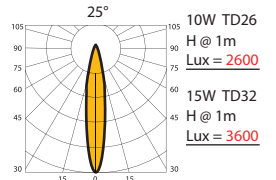
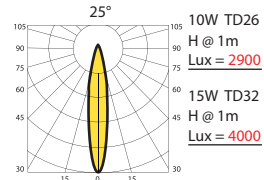
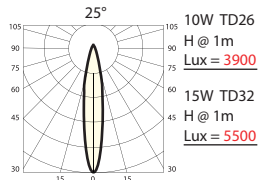

**New!**

## 15W TD32

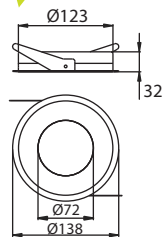

Power Consumption	15W
Field Angle	25° / 40° / 60° / 140°
Color Temperature	CW / NW / WW
CRI	≥ 70
Finish	White / Silver / Others
Surface Temperature	60 °C
Weight	390 ± 5 g

